

OWNER'S MANUAL

Gas Pro UTV Sprayers

Model: PROUTV65-GD-E (5303229)
Model: PROUTV105-GD-E (5303234)
 (Gas, D252 Diaphragm Pump, Electric)

Model: PROUTV65-GD-M (5303228)
Model: PROUTV105-GD-M (5303233)
 (Gas, D252 Diaphragm Pump, Manual)

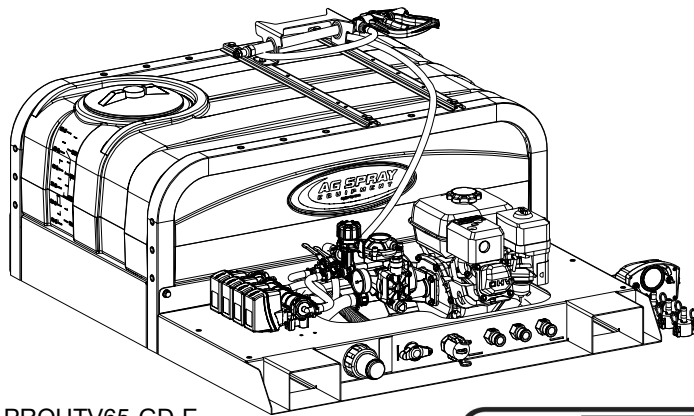

PROUTV65-GD-E
Shown

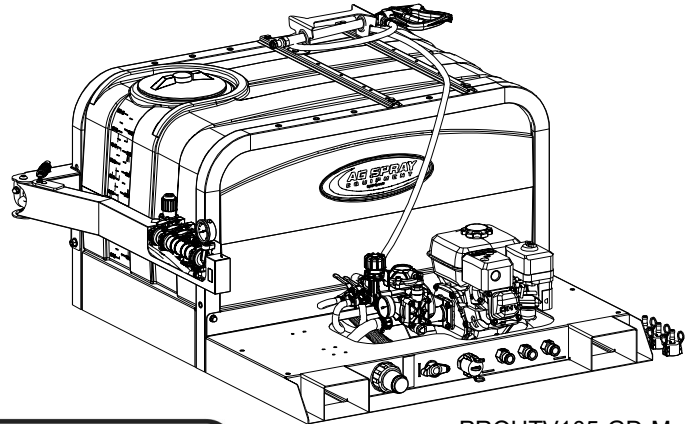

PROUTV105-GD-M
Shown



General Information

Thank you for purchasing this product. The purpose of this manual is to assist you in operating and maintaining your UTV sprayer.



WARNING: Cancer and Reproductive Harm.
www.P65Warnings.ca.gov



WARNING: To reduce the risk of injury, the user must read and understand the operator's manual before using this product.

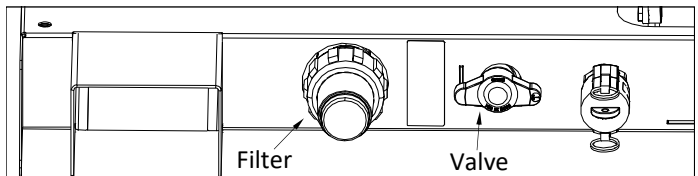

IMPORTANT REMINDER

This sprayer comes with a valve located on your intake line. Make sure the valve is in the "open" position before using this sprayer. Close this valve when cleaning strainer.

BEFORE RETURNING THIS PRODUCT FOR ANY REASON, PLEASE CALL

BAKERSFIELD, CA 877-724-2236	COLUMBUS, NE 800-274-1025	DOTHAN, AL 800-227-4098
FARGO, ND 701-280-2862	HOPKINSVILLE, KY 800-637-7172	MANKATO, MN 507-388-6295
NEWTON, KS 800-394-7662	PASCO, WA 800-634-2026	TEMPE, AZ 877-974-7166

If you should have a question or experience a problem with your Ag Spray Product: Visit our website @ www.agspray.com or call the Toll free number above. Our technical support representatives will be happy to help you.

In most cases a customer service rep. can resolve the problem over the phone.

To obtain prompt, efficient service, always remember to give the following information....

- Correct Part Description and/or part number
- Model number and Serial Number

Part descriptions and numbers can be obtained from the illustrated parts list section(s) of this manual.

Retain a copy of your receipt for your unit, as it will be required to validate any warranty service.

Warranted against manufacturer or workmanship defects from date of purchase with copy of receipt:

Homeowner Usage: One Year

Commercial Usage: 90 Days.



www.agspray.com

[5195668

(11/22)]

PROUTV SPRAYER

AG SPRAY PRO SERIES

Contents

Technical Specs.....	3	PROUTV65/105-GD-E Dimensions	10
Assembly and Operation	3	PROUTV65/105-GD-M Exploded Views	11 - 12
Testing the Sprayer and Maintenance	4	PROUTV65/105-GD-M Parts List	13
Tank Care and Winter Storage	5	PROUTV65/105-GD-M Dimensions.....	14
Troubleshooting	5 - 6	Boom Mount Kit Exploded View/Parts List.....	14
PROUTV65/105-GD-E Exploded Views	7 - 8	Warranty	16
PROUTV65/105-GD-E Parts List.....	9		

Gas Pro UTV Sprayers

Model: PROUTV65-GD-E (5303229)

Model: PROUTV105-GD-E (5303234)

(Gas, D252 Diaphragm Pump, Electric)

Approx. Sprayer Weight when filled w/water

PROUTV65-GD-E: 785 Lbs.

PROUTV105-GD-E: 1,140 Lbs.

Always check the vehicle load rating before using this sprayer. Do not exceed the recommended rating.

Model: PROUTV65-GD-M (5303228)

Model: PROUTV105-GD-M (5303233)

(Gas, D252 Diaphragm Pump, Manual)

Approx. Sprayer Weight when filled w/water

PROUTV65-GD-M: 850 Lbs.

PROUTV105-GD-M: 1,200 Lbs.

Always check the vehicle load rating before using this sprayer. Do not exceed the recommended rating.

~~~~~IMPORTANT~~~~~

Remove tank lid and be sure the tank is clean and free of any foreign material. Rinse tank out of any tank residue before filling with water to test.

~~~~~IMPORTANT~~~~~

It is VERY important to test this sprayer with plain water before actual spraying is attempted. This will enable you to check the sprayer for leaks without the possibility of losing any expensive chemicals.

~~~~~WARNING~~~~~



Read and Understand the Owner's Manual before using this sprayer. Test and use in accordance to instructions.

Read and Follow chemical label instructions and wear protective gear when filling, using, cleaning and servicing the sprayer.

Exercise Caution in vehicle handling when towing/hauling a filled sprayer to avoid loss of control or overturning.

Keep Sprayer and Spray materials away from other people, children and pets.

Do Not Turn on Power to the sprayer, until ready to spray in order to avoid unintentional spray release.

Do Not Use on steep slopes. A full sprayer could cause loss of control or overturn sprayer and vehicle.

Always operate up and down a slope, never across the face of a slope.

Keep all movement on slopes slow and gradual. Do not make sudden changes in speed, directions or turning. Do not start or stop suddenly when going uphill or downhill.

Stop on level ground, set the parking brake and shut off engine before leaving the operator's position for any reason.

Keep all parts in good condition and properly installed. Fix damaged or worn parts immediately.

Caution should be taken when towing and/or using any sprayer. This sprayer combined with the weight distribution, turning radius and speed of vehicle can result in damage to vehicle and/or sprayer or severe injury or death, if not used properly.

Improper use of this sprayer or handling of chemicals could result in serious injury or illness, or could cause damage to the environment.

PROUTV SPRAYER

AG SPRAY PRO SERIES

Technical Specifications

- 65 or 105 Gallon Corrosion-Resistant Polyethylene Tank
- ProSeries 22" HP Long Range Ergonomic Handgun
- 25 Ft. Handgun Hose
- 27 Ft. Max. Vertical Throw, 38 Ft. Horizontal Throw
- Molded-In Tank Baffle w/Sloped Floor
- Molded-In Outlet Fitting for Complete Cleanout
- Electric or Manual Valves
- Manual has 3-Section Control Swing Arm w/Position Detents
- Diaphragm Pump
- Tank Agitator

OPTIONS

- 50' Manual Hose Reel w/180° Swivel
- Booms: Traditional 13' to 28' or Boomless 40' Coverage

The PROFESSIONAL SERIES is designed with many features to make operation more user friendly with years of trouble free use.

Assembly Instructions

The sprayer is assembled already at the factory. The only assembly you will need to do is attaching optional boom or hose reel when purchased.

Before Operating the Sprayer

Read the operating instructions and then run the sprayer using only water for testing. Follow instructions under Testing the Sprayer. When everything tests all right, add the desired chemical mixture and water combination and start the spraying operation.

IMPORTANT: Remove tank lid and be sure the tank is clean and free of any foreign material. Rinse tank out of any tank residue before filling with water to test.

IMPORTANT REMINDER:

Add proper oil to the engine crankcase and gasoline to the gas tank. Always check the oil in the gear box. Refer to engine manual for correct oil type. Add SAE 30 to the sight level in the diaphragm pump. Fill the gear case with 90W gear lube until the gear lube runs out the side plug hole.

1. Add plain water to the tank and check the system for leaks. Open the suction line valve. Open the lever valves by the pressure regulator that are connected to the handgun line and jet agitator line.
Only fill the tank with what you're going to spray in a day, never leave chemicals sit in tank.
2. The pumping system includes an agitator, which will help keep the solution in suspension. Pressure to the agitator should never exceed 100 PSI. When spraying at pressures over 100 PSI, use the valve (in the agitator line) to throttle the pressure to the agitator by closing the valve. The valve may be opened slowly until the gauge reaches 100 PSI.

Do not exceed recommended pressure on pump or sprayer, as it may cause hoses to burst and will shorten pump life.

Operating the Sprayer

1. Rotate the regulator tab clockwise as far as possible (0 PSI). This aids in the starting of the engine.
2. Make sure handgun is in the "off" position and start the engine.
3. Open the handgun. Water should start to flow from the handgun immediately. Leave the regulator tab in position (0 PSI) for about 1 minute. Allow any air in the system to be worked out before attempting to spray. Rotate the tab in the opposite direction to increase the pressure.
4. The pressure regulator (red knob on top) may now be rotated to get the desired operating pressure. Operate the sprayer for a short time with plain water and inspect the system again for any leakage. The sprayer is ready to use.
5. The valve in the agitator line may be used to limit flow and pressure to the agitator.

NOTICE

1. DO NOT EXCEED recommended speed, pressure and temperature for the sprayer and pump.
2. High pressure spray can cause serious bodily injury. Handle with care. Grasp gun firmly before starting to spray. During spraying operation, hold gun firmly.
3. DO NOT put hands or fingers in front of the gun or point the gun at your body or anyone else.

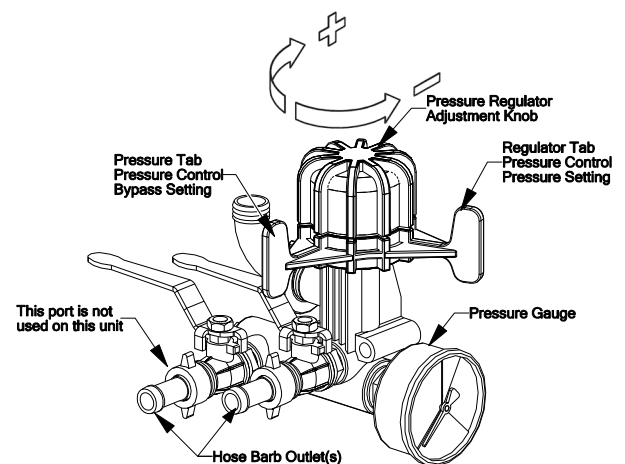

4. Before working on, servicing or making adjustments to equipment, disengage power, shut off engine, make sure all moving parts have stopped and all pressure in the system is relieved.
5. Perform periodic cleaning, maintenance and inspection of fittings and hoses for operator safety. Replace any fittings or hoses that are shown to have defects.
6. DO NOT use sprayer for pumping water or other liquid for human or animal consumption.
7. If equipment is used in freezing or near freezing conditions, protect pump and plumbing on sprayer from freezing. Drain liquid from system and add RV antifreeze.

Testing the Sprayer

NOTE:

It is very important to test this sprayer for leakage and proper spray patterns with plain water before chemical application is attempted. This will also give you the opportunity to familiarize yourself with the operation of the sprayer, without the possibility of losing any expensive chemicals.

1. Fill the tank about 1/2 full with plain water.
2. Open the valve in the suction line and allow water to flow to the pump. The valve is located at this point to enable the strainer to be taken apart for cleaning, while solution remains in the tank.

CAUTION: Always be sure that the water (or solution) has reached the pump before starting your sprayer. If the pump is allowed to run dry, serious damage to the pump will result. Do not run your sprayer with the spray nozzle line closed AND the bypass line closed. Doing this will damage the pump.

3. It is always best to start the sprayer at little or no pressure. Opening of the bypass line will decrease pressure and closing it will increase pressure.

The bypass line is the "pressure control" for the entire plumbing system. The more it is open, the lower your line pressure. Almost fully closed provides maximum pressure. **NEVER run your system with this valve 100% closed.**

4. You may now start the sprayer engine following the engine manufacturers instructions. Let the sprayer run at low pressure until water has reached the spray nozzle and all air has been purged from the system.
5. The pressure should now be increased to 30 - 125 PSI. Operate the sprayer at this increased pressure for 3 to 5 minutes, thoroughly testing the unit before adding chemicals.

When everything tests all right (no leaks and good pressure), add the desired chemicals to the mixture and water combination and start your spraying operation. Adjust the pressure and spray as you did in the testing procedure. The sprayer should now be ready to use.

Conditions of weather and terrain must be considered when setting the sprayer. Do not spray on windy days. Protective clothing must be worn in some cases.

Be sure to read the chemical label(s) before application!

Maintenance During/After Spraying

Periodically close the suction line valve and check the line strainer and clean the screen. Stop the engine and shut off the valve near the strainer. Remove the bowl and screen portions of the strainer and wash them free from all impurities. You may also drain the tank by uncoupling the suction line near the strainer. Open the valve and pour the contents into another container. Read the chemical label for disposal instructions.

Proper care and maintenance will keep your pump wear at a minimum and will keep it running smoothly and trouble-free for a long time and prolong the life of your sprayer.

Change the engine oil per the engine manufacturer's specifications. Oil changes in the pump should be done after each 200 hours of use or at least once a season. To fill the pump with oil, pour oil slowly into the sight tube while slowly turning the pump shaft. Turning the pump shaft purges all of the air from the crankcase. Use SAE 30 motor oil.

Refer to the pump and motor owners manuals for their respective replacement parts and service recommendations.

After use, fill the sprayer tank part way with water. Start the sprayer and allow the water to pump through the entire plumbing system and nozzles. Drain and then refill half full with plain water, add the recommended amount of good quality tank cleaner such as FIMCO Sprayer Tank Neutralizer and Cleaner. (If no tank cleaner is available, you may substitute dish soap for this step, about 1-2 oz. per gallon). But a neutralizer/cleaner should be used to thoroughly clean the system. Turn sprayer on and circulate through system for 15 minutes and then spray out through handgun nozzle (and boom nozzles if applicable). Refill tank half way with clean water and repeat. Follow the chemical manufacturer's disposal instructions of all wash or rinsing water.

WARNING: Never pump corrosive or abrasive liquids as these will cause rapid wear or deterioration of body, rotor, shaft and seals in the pump. Never run pump dry. Some chemicals will damage the pump valves if allowed to soak untreated for a length of time! ALWAYS flush the pump as instructed after each use. DO NOT allow chemicals to sit in the pump for extended times of idleness. Failure to follow this warning will void the product warranty.

Follow the chemical manufacturer's instructions on disposal of all waste water from the sprayer.

Tank Care & Maintenance

Warning: Do not use the tank as a container for fuel oils, kerosene, gasoline or any other petroleum distillate product. All polyolefins are softened and permeated by such products. In an enclosed area the vaporization of these materials from the outside surface of the tank could create a dangerous condition.

The tank should not be used as a pressure vessel nor used with chemicals or solutions having a weight of more than 12 pounds per gallon.

Store the tank in a dry dark place when not in use. Storage out of sunlight will prolong the life of the tank.

Do not drop, strike or kick the tank, especially at low temperatures. Tanks become brittle and are subject to cracking at temperatures below 20° Fahrenheit.

Always flush the tank with water and a neutralizing agent at the end of each use, to prevent contamination of solutions.

Winter Storage

Prepare the sprayer for end-of-season storage by running RV antifreeze through the system. This will keep internal parts lubricated, protect against corrosion and keep the unit from freezing. *Note: RV antifreeze is non-toxic and biodegradable and generally safer for the environment than automotive antifreeze.*

Before storing your sprayer for winter or long term storage, thoroughly clean and drain it as much as possible. Then pour enough pink RV antifreeze into the tank so that when the pump is turned on you can pump the antifreeze throughout the entire plumbing system, including the bypass.

Make sure to operate the boom (if applicable) and handgun until you see pink fluid spraying from the nozzles. Leave any remaining antifreeze in the tank. Before your next usage, rinse the antifreeze from the sprayer with clean water. It is nearly impossible to drain all of the water from the sprayer and any trapped water can freeze in cold weather and damage parts of the sprayer. Pumping the antifreeze through the system will displace the water and help prevent this damage.

Removing from storage: drain the antifreeze. Fill the tank with fresh water and run through the system. Dispose of antifreeze and flush water properly.

Removing the pump from the sprayer and storing it in a heated area will also prevent costly damage to the pump. This should be done AFTER the pump has been neutralized and flushed out with Fimco Neutralizer and Cleaner. Plug the inlet and outlet ports if storing inside.

PRO SERIES Long Range Ergonomic Handguns

Technical Specifications:

- Adjustable Spray Pattern
- Convenient Hanger Hole
- Chemical Resistant Construction
- 38' Horizontal, 27' Vertical Maximum Spray Distance
- Adjustable On/Off Trigger Stop for Precise Spray Pattern
- Aluminum Barrel
- Integrated Trigger Lock
- No Drip Shut Off
- 600 PSI, 8 GPM

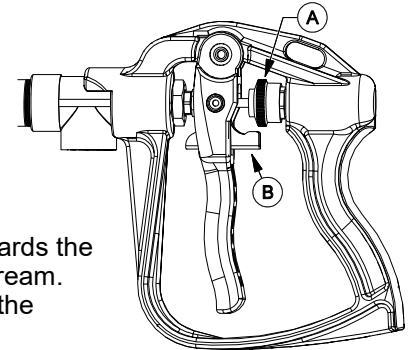

To adjust the spray pattern, the nut needs to be adjusted (Ref. A). Spinning it off, towards the lever, will make a cone pattern and spinning it on, away from the lever, will make a stream. The lever (Ref. B), is the lock that can be used to lock the lever when pulled, holding the valve open. Squeezing the trigger, will release the lock.

There is a valve on the intake line. It is at this location so you can shut off the flow of solution to access your system's filter screen for cleaning.

Checking/Cleaning the sprayer's filter/screen:

- ◆ Start your pump and before it shuts off, reach down and shut the valve to the 'Closed' position, then shut off your pump.
- ◆ Unscrew the bowl of the filter to access the screen.
- ◆ Remove the screen and clean as necessary. Replace when done and reassemble the entire assembly.
- ◆ Make sure the valve is turned to the 'Open' position before restarting your pump.

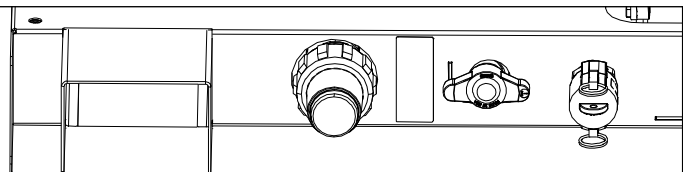

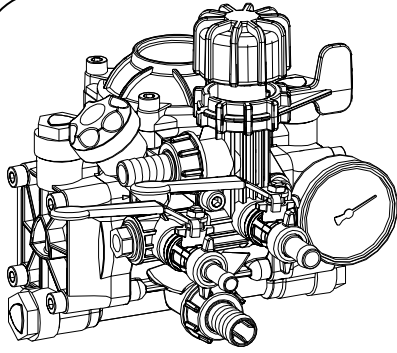

AR D252 Diaphragm Pump w/GR20 Control for 3/4 Shaft

- With GR20 Control Unit with working pressure regulating valve, by-pass control lever and glycerin bath pressure gauge.
- Parts in contact with pumped liquids in plastic-coated aluminum and body in aluminum.
- Die-Cast casing with oil-immersed mechanism and clear plastic tank for visual level checking.
- 3/4" Inlet and 1/2" NPT Outlet.
- Max. Temp: 140° F.



- Clean and rinse your pump after each use with Fimco Tank Neutralizer.
- Winterize your pump or sprayer by rinsing, draining and running RV Antifreeze through it before storing for the winter.
- Use clean water for your spray mixture.
- Store inside a building when not in use.



- Use to pump bleach.
- Use to pump petroleum products, such as diesel fuel, gasoline or kerosene.
- Leave your pump sit with spray mixture in it for extended periods.
- Use dirty or unfiltered water for spraying.

Troubleshooting		
Symptom	Probable Cause(s)	Corrective Action
Pump Does Not Prime	One or more valves are seating improperly.	Examine valve seatings and clean them.
	Clogged Strainer	Clean Strainer.
	Intake circuit not airtight.	Tighten, repair or replace hoses and fittings as necessary.
	Control unit switching lever on "pressure" setting.	Move control switching lever to "By-pass" setting.
Pump Does Not Require the Required Pressure	Seat and plate of intake and delivery valves worn.	Replace the worn valves.
	Nozzles worn or too large in dia.	Replace worn nozzles. Use nozzles of suitable diameter.
	Restriction in intake circuit.	Remove restriction from the circuit.
	Intake filter clogged.	Clean the filter.
Pressure Gauge Needle Wobbles, Pressure Pulsating	Intake circuit not airtight.	Clean or replace the intake and delivery valves.
	Residual air left inside pump.	Discharge the air by opening a ball valve/central unit connected to the delivery side with the pump in operation.
	Valve plate stuck to it's seat.	Tighten, repair or replace hoses and fittings as necessary.
	Pressure accumulator deflated.	Inflate accumulator to the correct pressure.
Uneven Flow of Liquid	Pressure accumulator deflated.	Inflate accumulator to the correct pressure.
	One or more valves are seating improperly.	Examine valve seatings and clean them.
Increase in Noise & Drop in Oil Level (Pump Cavitation)	Restriction in intake circuit.	Remove restriction from the circuit.
	Intake filter clogged.	Clean the filter.
	Oil Level is too low.	Add oil to the proper level.
Oil on Pump Body or Base	Oil seal on pump shaft worn.	Replace seal.
	Oil pressure inside pump too high.	Restore correct oil level in tank.
Pump Using too Much Oil or Oil Whitish in Color	Diaphragm Ruptured.	Stop pump at once. Replace Diaphragm.
Engine will not start	Engine will not start	See engine owner's manual

Legend:

A = 65 Gallon

B = 105 Gallon

See Parts List Page 9

Exploded View:
PROUTV65-GD-E
(5303229)
PROUTV-105-GD-E
(5303234)

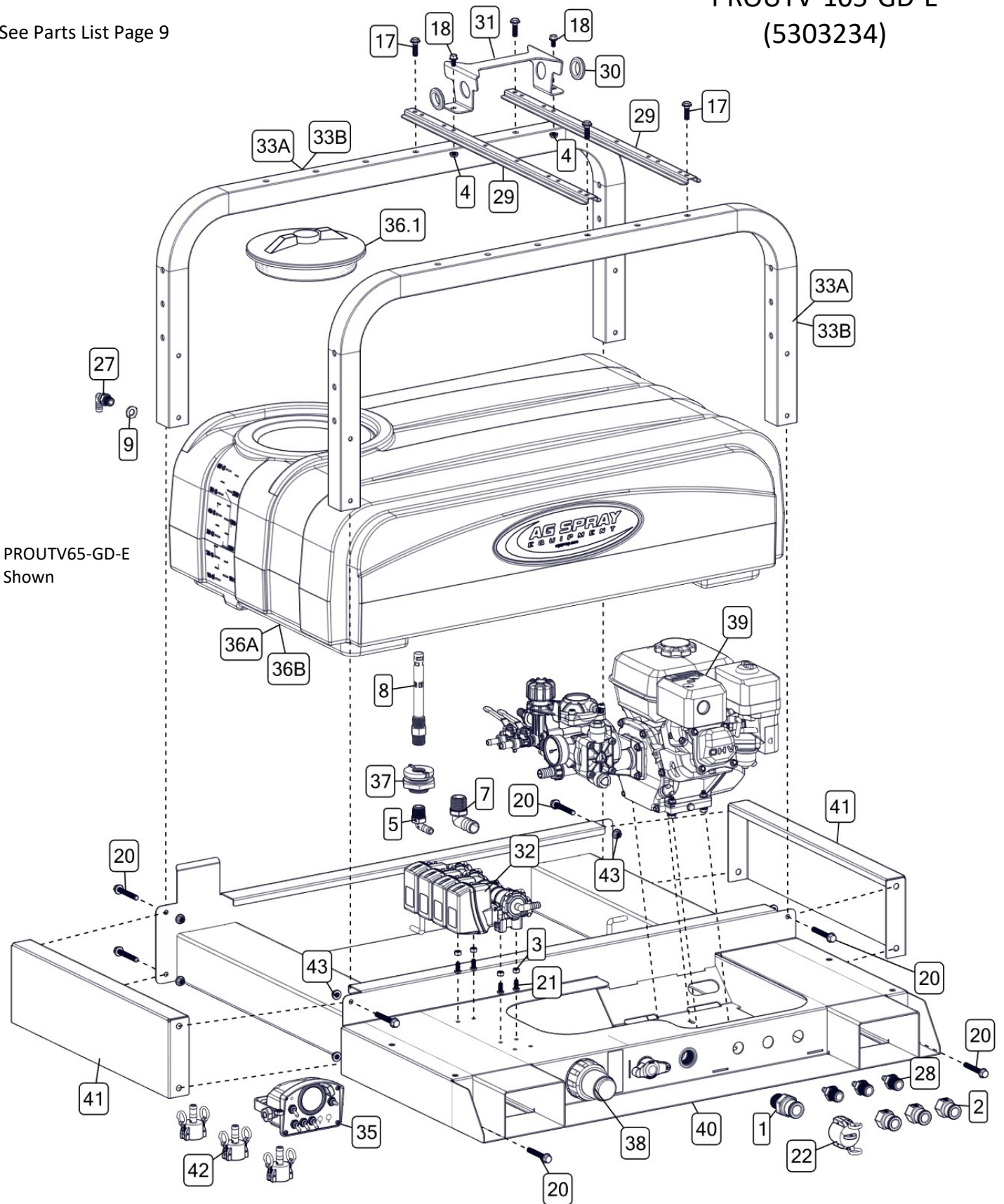

PROUTV65-GD-E
Shown

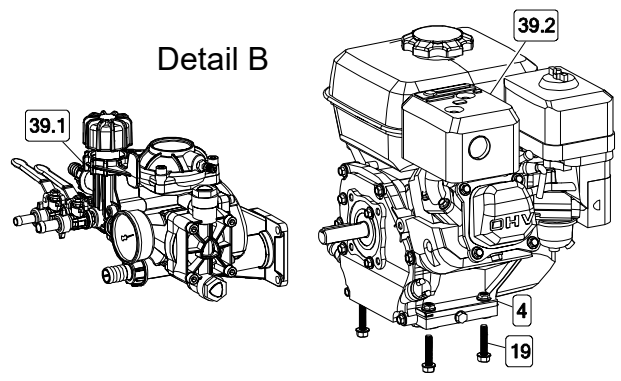
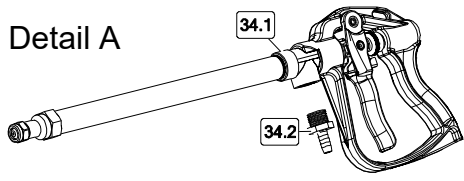

Legend:

A = 65 Gallon

B = 105 Gallon

See Parts List Page 9

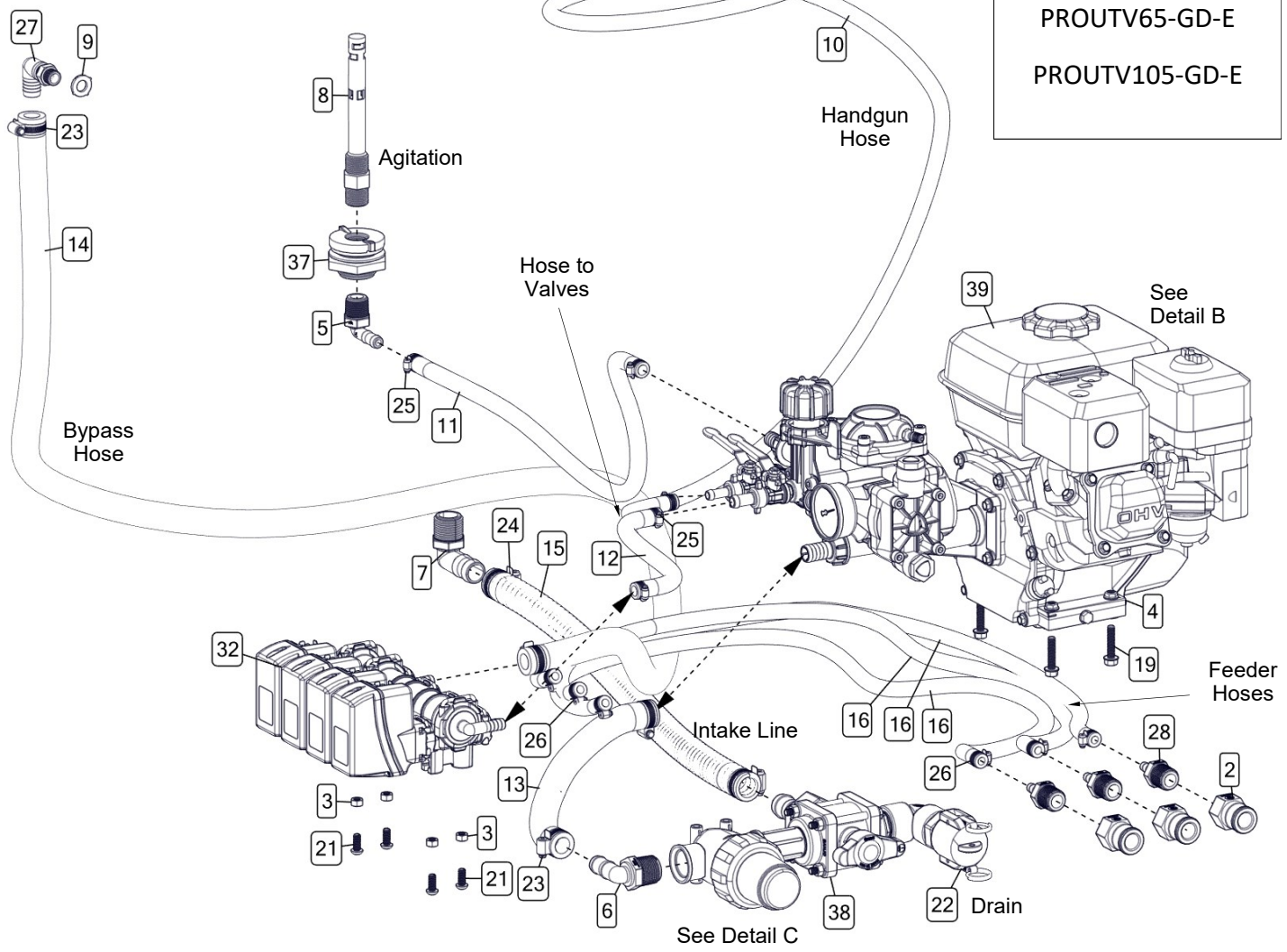

Plumbing Detail
 PROUTV65-GD-E
 PROUTV105-GD-E

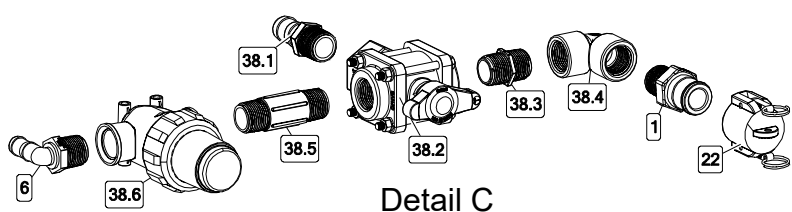

Exploded View: PROUTV65-GD-E (5303229) & PROUTV-105-GD-E (5303234)

Ref. #	Part #	Description	65-GD-E	105-GD-E
1	5005141	Banjo 1" Male Camlock x 1" MNPT Adapter	1	1
2	5005156	Banjo 3/4" Male Camlock x 3/4" FPT Adapter	3	4
3	5006040	5/16-18 Hex Nut	4	4
4	5006307	5/16-18 Serrated Flng Hex Nut	6	6
5	5010332	Banjo 3/4" MPT x 1/2" 90° HB	1	1
6	5010335	Banjo 1" MPT x 3/4" 90° HB	1	1
7	5010336	Banjo 1" MPT x 1" 90° HB	1	1
8	5014014	3/4" Jet Agitator	1	1
9	5016066	1" Rubber Washer	1	1
10	5020099	Hose, 3/8"-2 Brd. x 25 Ft.	1	1
11	5020162	Hose, 1/2"-2 Brd. x 36"	1	1
12	5020193	Hose, 1/2"-2 Brd. x 9"	1	1
13	5020290	Hose, 3/4"-2 Brd. x 16"	1	1
14	5020976	Hose, 3/4"-2 Brd. x 83"	1	1
15	5020964	Hose, 1" 36" KF1300BLK	1	1
16	5020969	Hose, 3/8"-2Brd x 4'	3	3
17	5034592	3/8-16 x 1.25 Flng Hex Bolt	4	4
18	5034634	5/16-18 x 0.625 Flng Hex Bolt	2	2
19	5034638	5/16-18 x 1.50 Flng Hex Bolt (Full Thread)	4	4
20	5034668	3/8-16 x 2.75 Flng Hex Bolt (Full Thread)	8	8
21	5034867	5/16"-18 x 3/4" Button Head Screw	4	4
22	5046077	Banjo 1" - 1 1/4" Female Camlock Dust Cap	1	1
23	5051024	Hose Clamp (3/4")	4	4
24	5051025	Hose Clamp (1")	2	2
25	5051114	Hose Clamp (3/8"-1/2")	4	4
26	5051144	Hose Clamp (3/8")	8	8
27	5056097	Poly Elbow, 1 1/16" MPS x 3/4" HB	1	1
28	5067181	Banjo 3/4" MPT x 3/8" HB	3	3
29	5070152	Pro UTV Mounting Strut	2	2

Ref. #	Part #	Description	65-GD-E	105-GD-E
30	5075014	Rubber Grommet (Black)	2	2
31	5078833	Handgun Bracket	1	1
32	5143554	ARAG Electronic Control Manifold Assembly	1	1
33A	5144150	65 Gallon Hoop	2	--
33B	5144151	105 Gallon Hoop	--	2
34	5163150	22" HP Spray Gun with 3/8" Hose Barb	1	1
34.1	5163136	High Pressure Aluminum Spray Gun 22"	1	1
34.2	5067130	Poly Fitting, 1/2" MNPT x 3/8" HB	1	1
35	5164315	3 Section Electric Control Kit w/Harness	1	1
36A	5169356	65 Gallon Pro UTV Tank (Yellow)	1	--
36AB.1	60032	Norwesco 8" Lid w/Vent & Ring Assembly	1	1
36B	5169358	105 Gallon Pro UTV Tank (Yellow)	--	1
37	5273736	3/4" Double-Threaded Tank Bulkhead Fitting	1	1
38	5281959	Pro UTV Valve/Strainer Assembly, Gas	1	1
38.1	5067187	Banjo 1" NPT Thread x 1" HB	1	1
38.2	BJBLV100	Banjo 1" 3-Way Bottom Load Poly Valve	1	1
38.3	5011201	Banjo 1" MPT x 1" MPT - Short Poly Pipe Nipple	1	1
38.4	5010316	Banjo 1" FPT x 1" FPT 90° Poly Elbow	1	1
38.5	5011166	Banjo 1" MNPT x 1" MNPT - 4" Poly Pipe Nipple	1	1
38.6	5116475	Line Filter, 1" FNPT, 50 Mesh	1	1
39	5281964	AR D252-GR-GCI Pump w/GR20 Control & GX160 HONDA	1	1
39.1	5151158	D252 Diaphragm Pump w/GR20 Control for 3/4" Shaft	1	1
39.2	5152058	Honda Engine, 5.5 HP (OHV) (Less Gear Reduction)	1	1
40	5281970	Pro UTV Frame Weldment, Gas	1	1
41	5058227	Pro UTV Frame Side Cover	2	2
42	BJ050C	Banjo 3/4" Female Camlock Lever x 1/2" HB	3	3
43	5006259	3/8-16 Serrated Flng Hex Nut	8	8

Legend:

A = 65 Gallon

B = 105 Gallon

Dimensions:

PROUTV65-GD-E (5303229)

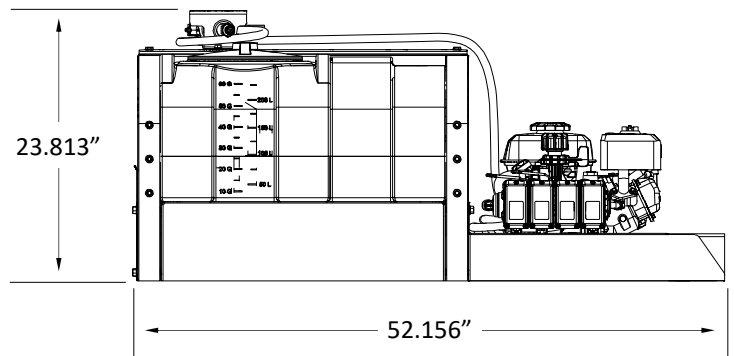
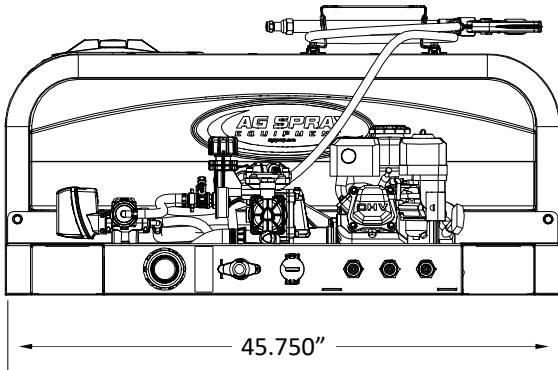

PROUTV105-GD-E (5303234)

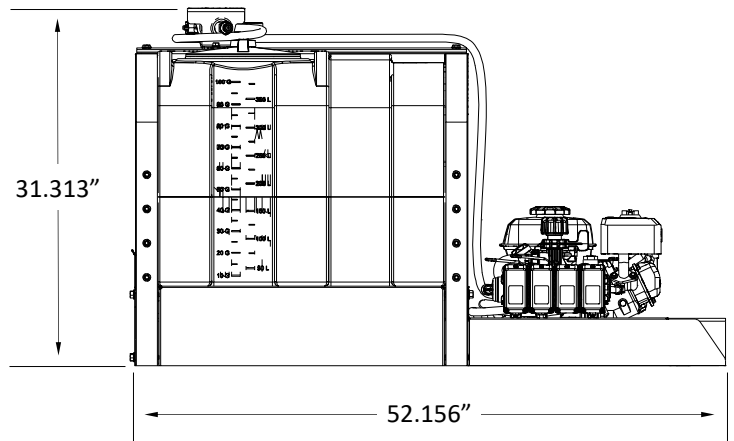
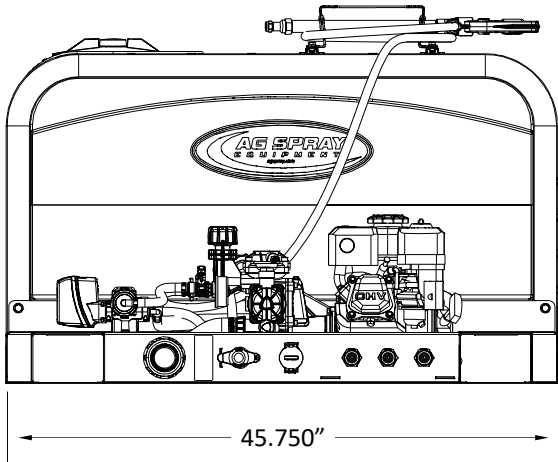

Legend:

A = 65 Gallon

B = 105 Gallon

See Parts List Page 13

Exploded View:
PROUTV65-GD-M
(5303228)
PROUTV-105-GD-M
(5303233)

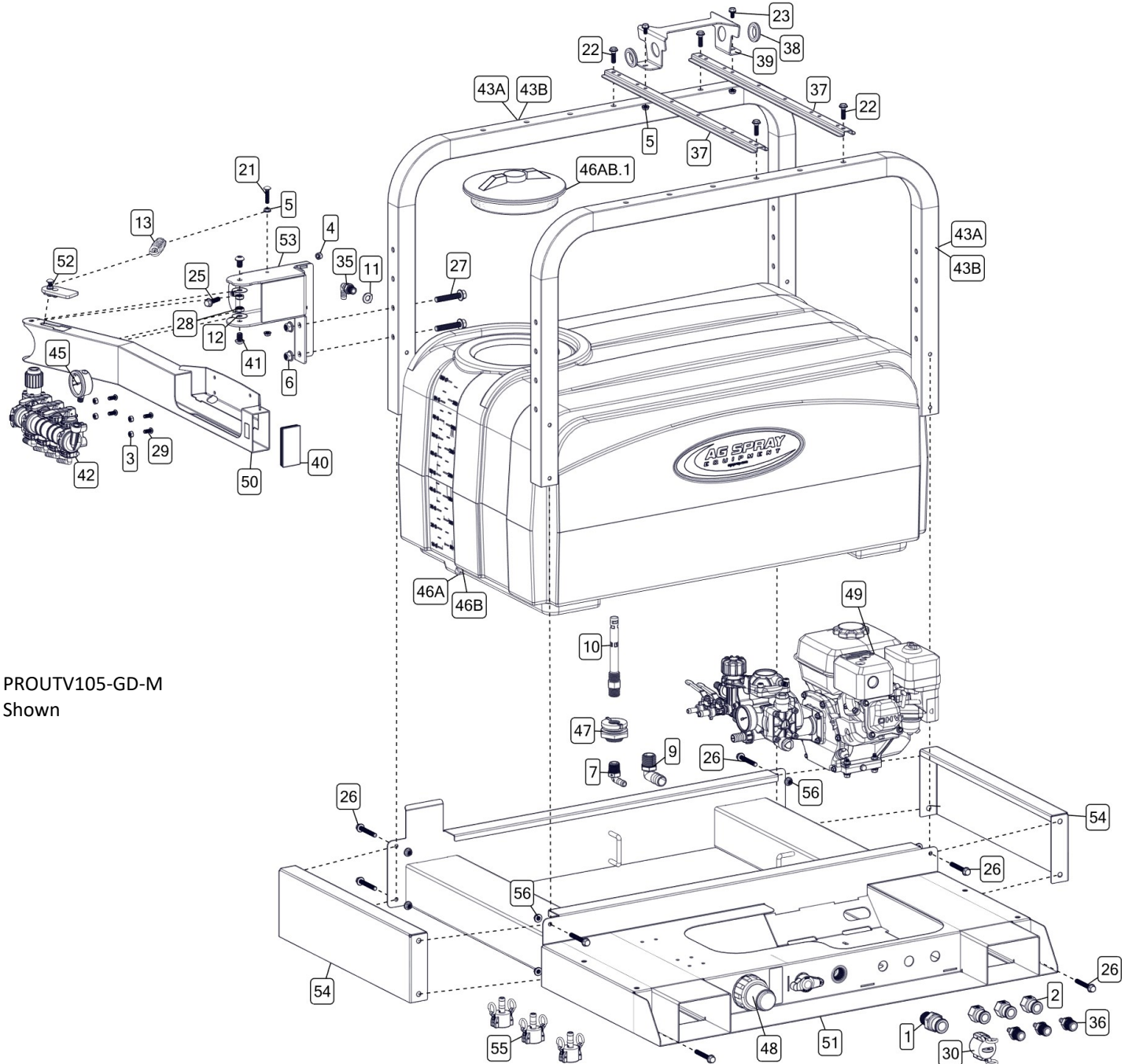

PROUTV105-GD-M
Shown

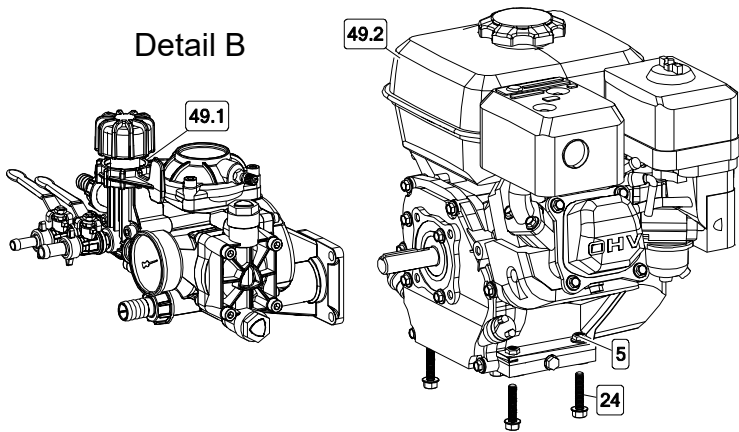
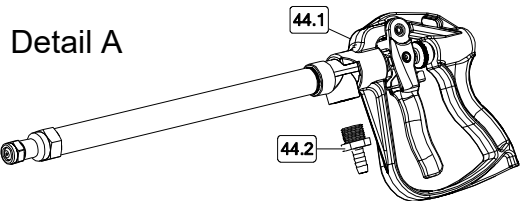

Legend:

A = 65 Gallon

B = 105 Gallon

See Parts List Page 13

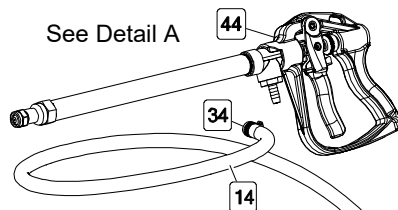

Handgun
Hose

Plumbing Detail
PROUTV65-GD-M

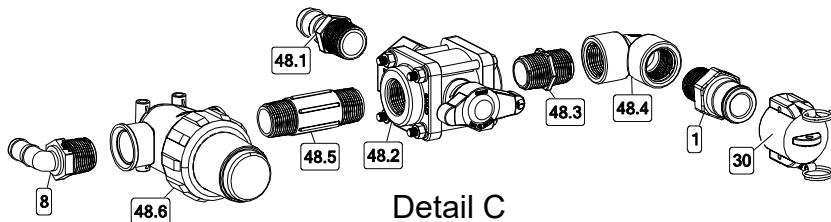
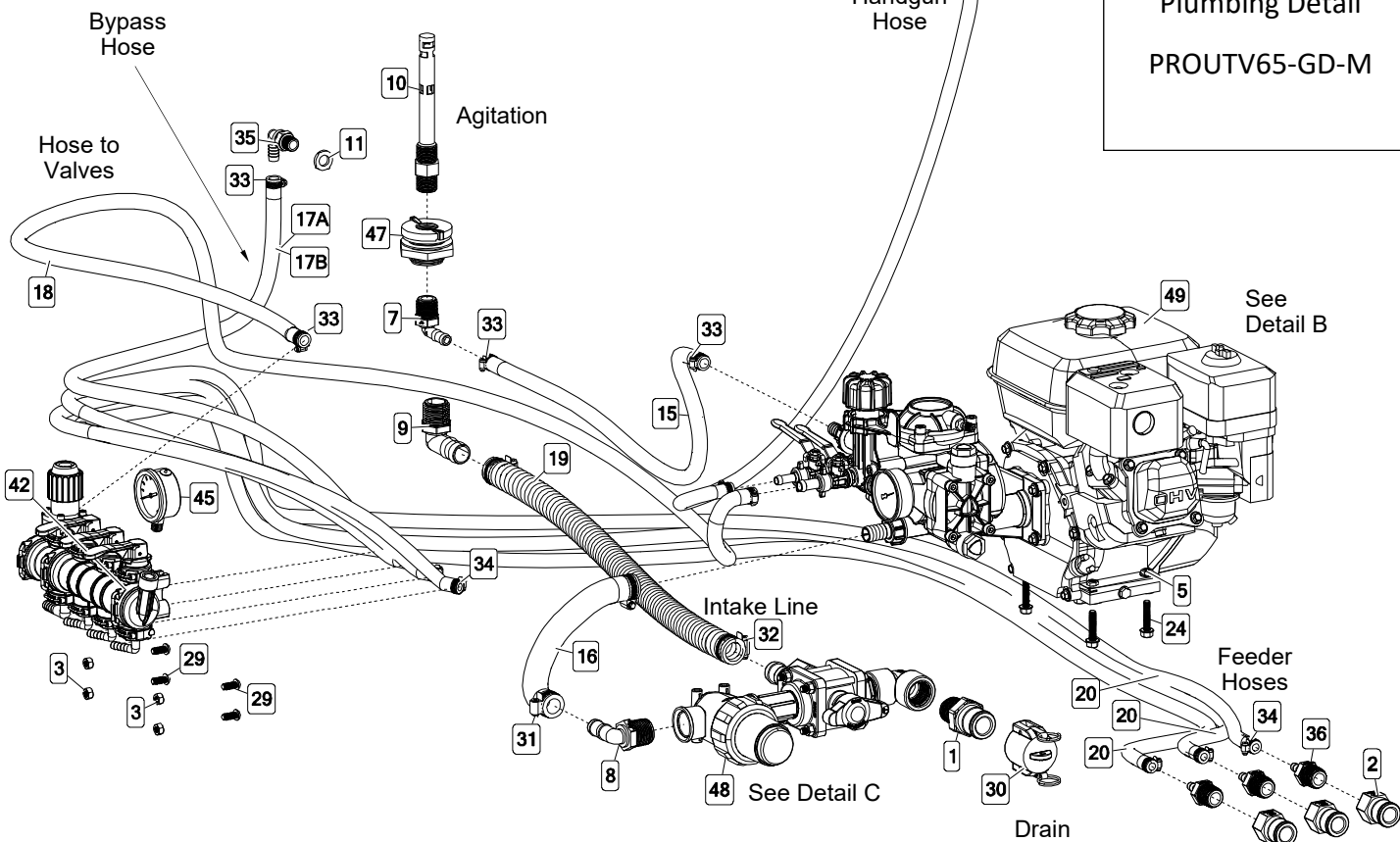

Exploded View: PROUTV65-GD-M (5303228) & PROUTV-105-GD-M (5303233)

Ref. #	Part #	Description	65-GD-M	105-GD-M
1	5005141	Banjo 1" Male Camlock x 1" MNPT Adapter	1	1
2	5005156	Banjo 3/4" Male Camlock x 3/4" FNPT Adapter	3	3
3	5006040	5/16-18 Hex Nut	4	4
4	5006054	3/8-16 Hex Nut	1	1
5	5006307	5/16-18 Serrated Flng Hex Nut	8	8
6	5006399	1/2-13 Flng Top-Lock Hex Nut	2	2
7	5010332	Banjo 3/4" MNPT x 1/2" 90° HB	1	1
8	5010335	Banjo 1" MNPT x 3/4" 90° HB	1	1
9	5010336	Banjo 1" MNPT x 1" 90° HB	1	1
10	5014014	3/4" Jet Agitator	1	1
11	5016066	1" Rubber Washer	1	1
12	5016321	Nylon Flat Washer, .5ID, 1.5 OD, .031 Thick	2	2
13	5019759	4" Tapered Extension Spring	1	1
14	5020099	Hose, 3/8"-2 Brd. x 25 Ft.	1	1
15	5020162	Hose, 1/2"-2 Brd. x 36"	1	1
16	5020290	Hose, 3/4"-2 Brd. x 16"	1	1
17A	5020162	Hose, 1/2"-2 Brd. x 36"	1	--
17B	5020298	Hose, 1/2"-2 Brd. x 48"	--	1
18	5020963	Hose, 1/2"-2 Brd x 9'	1	1
19	5020964	Hose, 1" x 36" KF1300BLK	1	1
20	5020968	Hose, 3/8"-2 Brd x 10'	3	3
21	5034477	5/16-18 x 1.50 Carriage Bolt	1	1
22	5034592	3/8-16 x 1.25 Flng Hex Bolt	4	4
23	5034634	5/16-18 x 0.625 Flng Hex Bolt	2	2
24	5034638	5/16-18 x 1.50 Flng Hex Bolt (Full Thread)	4	4
25	5034663	3/8-16 x 1.50 Flng Hex Bolt	1	1
26	5034668	3/8-16 x 2.75 Flng Hex Bolt (Full Thread)	8	8
27	5034697	1/2-13 x 2.75 Flng Hex Bolt (Full Thread)	2	2
28	5034863	1/2-13 Low Profile Nylon Lock Nut	2	2
29	5034867	5/16"-18 x 3/4" Button Head Screw	4	4
30	5046077	Banjo 1" - 1/4" Female Camlock Dust Cap	1	1
31	5051024	Hose Clamp (3/4")	2	2
32	5051025	Hose Clamp (1")	2	2
33	5051114	Hose Clamp (3/8"-1/2")	6	6
34	5051144	Hose Clamp (3/8")	8	8
35	5056095	Poly Elbow, 11/16" MPS x 1/2" HB	1	1

Legend:

A = 65 Gallon

B = 105 Gallon

Ref. #	Part #	Description	65-GD-M	105-GD-M
36	5067181	Banjo 3/4" NPT x 3/8" HB	3	3
37	5070152	Pro UTV Mounting Strut	2	2
38	5075014	Rubber Grommet (Black)	2	2
39	5078833	Handgun Bracket	1	1
40	5102137	Rectangle Cap Plug 2" x 4"	1	1
41	5117351	1/2-13 x 3/4" Button Head Screw	2	2
42	5143555	Regulator Valve 3 Section Valve Assembly	1	1
43A	5144150	65 Gallon Hoop	2	--
43B	5144151	105 Gallon Hoop	--	2
44	5163150	22" HP Spray Gun with 3/8" Hose Barb	1	1
44.1	5163136	High Pressure Aluminum Spray Gun 22"	1	1
44.2	5067130	Poly Fitting, 1/2" MNPT x 3/8" HB	1	1
45	5167031	Gauge, Liquid-Filled, 0-100 PSI	1	1
46A	5169356	65 Gallon Pro UTV Tank (Yellow)	1	--
46AB.1	60032	Norwesco 8" Lid w/Vent & Ring Assembly	1	1
46B	5169358	105 Gallon Pro UTV Tank (Yellow)	--	1
47	5273736	3/4" Double-Threaded Tank Bulkhead Fitting	1	1
48	5281959	Pro UTV Valve/Strainer Assembly, Gas	1	1
48.1	5067187	Banjo 1" NPT x 1" HB	1	1
48.2	BJBLV100	Banjo 1" 3-Way Bottom Load Poly Valve	1	1
48.3	5011201	Banjo 1" MNPT x 1" MNPT - Short Poly Pipe Nipple	1	1
48.4	5010316	Banjo 1" FNPT x 1" FNPT Poly Elbow 90°	1	1
48.5	5011166	Banjo 1" MNPT x 1" MNPT - 4" Poly Pipe Nipple	1	1
48.6	5116475	Line Filter, 1" FNPT, 50 Mesh	1	1
49	5281964	AR D252-GR-GCI Pump w/GR20 Control & GX160 Honda	1	1
49.1	5151158	AR D252 Diaphragm Pump w/GR20 Control for 3/4 Shaft	1	1
49.2	5152058	Honda Engine, 160cc (OHV) (Less Gear Reduction)	1	1
50	5281969	Manual Control Arm Weldment	1	1
51	5281970	Pro UTV Frame Weldment, Gas	1	1
52	5281971	Control Arm Detent Plate	1	1
53	5281972	Manual Control Arm Mount Weldment	1	1
54	5058227	Pro UTV Frame Side Cover	2	2
55	BJ050C	Banjo 3/4" Female Camlock, 1/2" HB	2	3
56	5006259	3/8-16 Serrated Flng Hex Nut	8	8

PRO UTV Boom Mount Kit for Gas Units

PROUTV-BMKIT
(5282426)

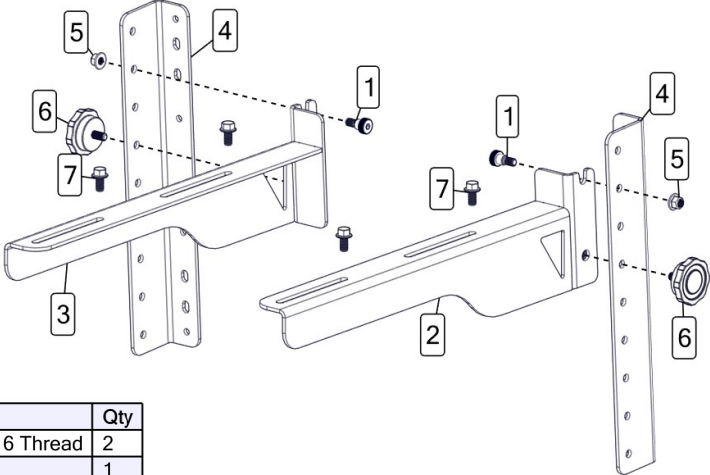

Ref. #	Part #	Description	Qty
1	5034868	Shoulder Bolt, 1/2" Dia, 3/8" Length, 3/8"-16 Thread	2
2	5095991-BLK	LH Boom Mount	1
3	5095992-BLK	RH Boom Mount	1
4	5070161-BLK	479/PX Boom Mount Bracket	2
5	5006345	3/8-16 Fling Top-Lock Hex Nut	2
6	5088027	8 Lobe Plastic Knob, 3/8"-16 Thread	2
7	5034660	3/8-16 x 0.75 Fling Hex Bolt	4

Dimensions:

PROUTV65-GD-M (5303228)

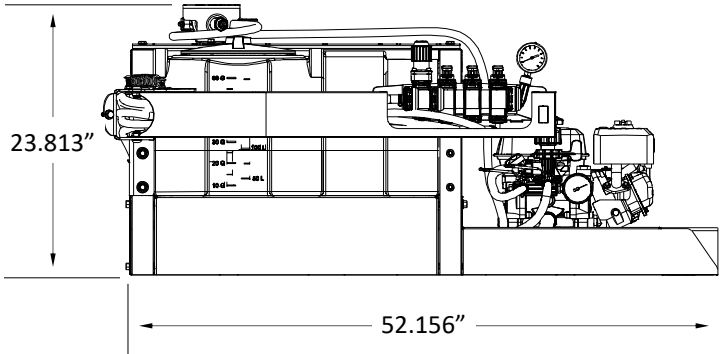
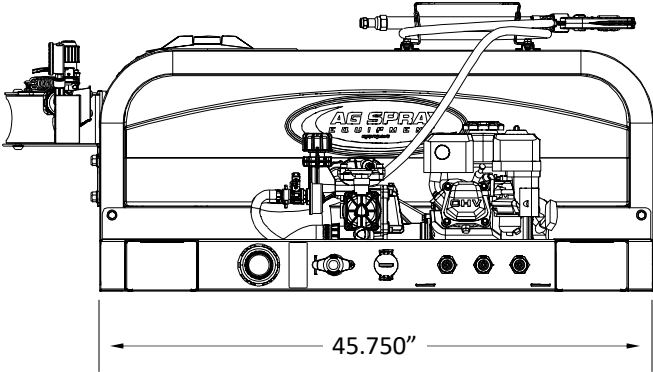

PROUTV105-GD-M (5303233)

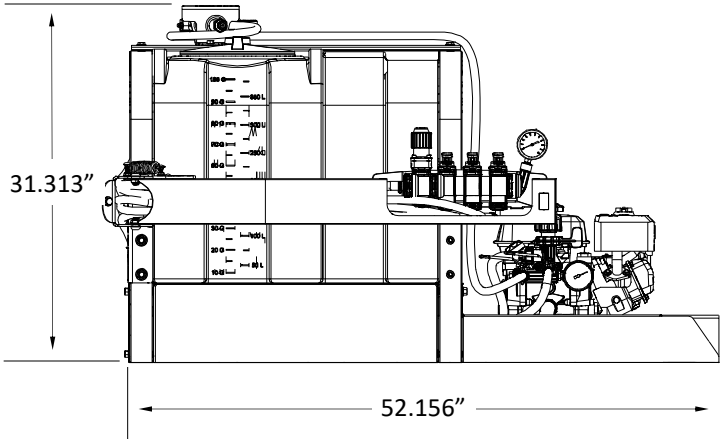
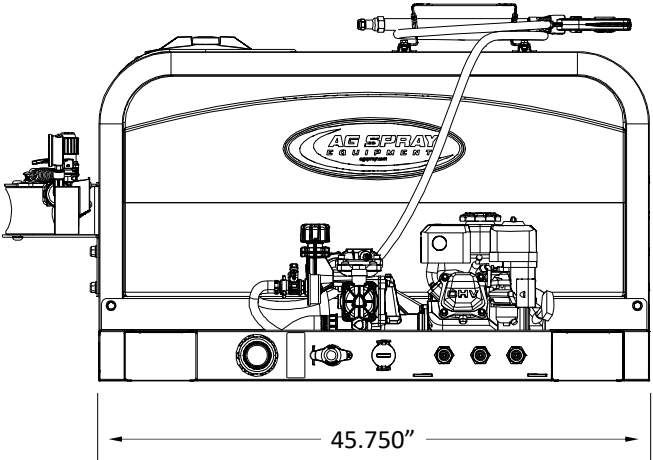

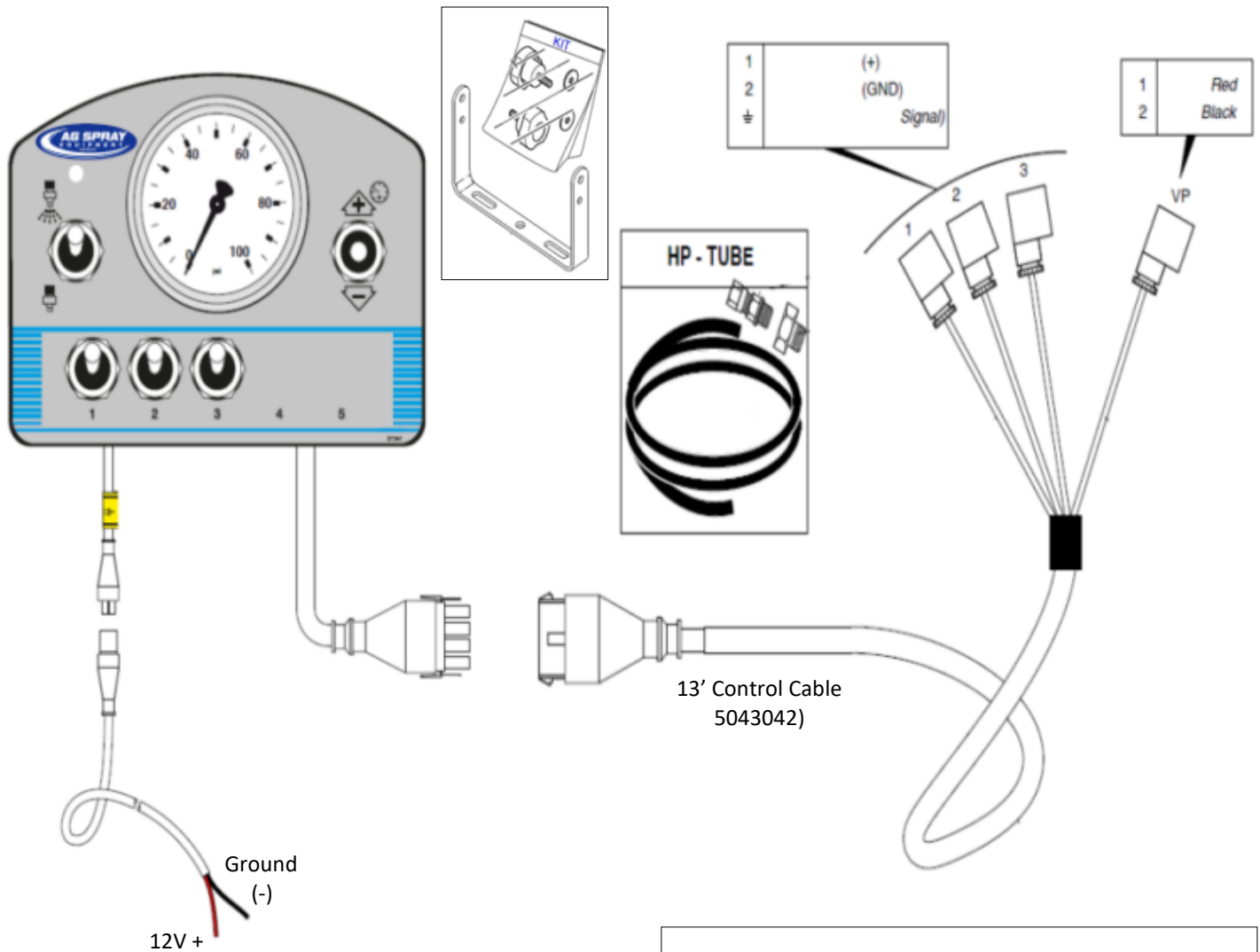

PRO UTV with Electric Control will require the control box be connected to 12VDC.

Install the control box in a convenient place within reach of the operator by bolting the control box mounting bracket to the vehicle.

Route the wiring harness and pressure tubing away from excessive heat and avoid pinching.

Plug control box harness to control cable, push pressure tubing into the back of the pressure gauge connection port.

OPTIONAL



Pressure Tube Coupling



Pressure Tubing Extension 4

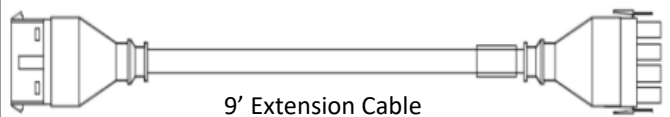

9' Extension Cable

Item #	Description
5043043	Extension Cable 9 Feet
5100968	*Pressure Tubing 4 MM Extension 18 Feet
5057220	*Pressure Tubing Coupling 4 MM

(*If an extension cable is needed, the pressure tubing extension and coupler will also be required)

Warranty

LIMITED WARRANTY FOR NEW AG SPRAY EQUIPMENT

WHO MAY USE THIS LIMITED WARRANTY. This limited warranty (the "Limited Warranty") is provided by Ag Spray Equipment to the original purchaser ("you") of the Equipment (as defined below) from Ag Spray Equipment or one of Ag Spray Equipment's authorized dealers. This Limited Warranty does not apply to any subsequent owner or other transferee of the Equipment. THIS LIMITED WARRANTY GIVES YOU SPECIFIC LEGAL RIGHTS, AND YOU MAY ALSO HAVE OTHER RIGHTS WHICH VARY FROM STATE TO STATE.

WHAT THIS LIMITED WARRANTY COVERS AND FOR HOW LONG. Ag Spray Equipment warrants that any new Equipment will be free from defects in material and workmanship for a period of **one (1) year** (homeowner), **90 days** (commercial user), after delivery of the Equipment to you (the "Warranty Period"). Warranty Period is not extended if Ag Spray Equipment repairs or replaces the Equipment.

WHAT IS NOT COVERED BY THIS LIMITED WARRANTY. This Limited Warranty does not apply to: (1) used Equipment; (2) any Equipment that has been altered, changed, repaired or treated since its delivery to you, other than by Ag Spray Equipment or its authorized dealers; (3) damage or depreciation due to normal wear and tear; (4) defects or damage due to failure to follow Ag Spray Equipment's operator's manual, specifications or other written instructions, or improper storage, operation, maintenance, application or installation of parts; (5) defects or damage due to misuse, accident or neglect, "acts of God" or other events beyond Ag Spray Equipment's reasonable control; (6) accessories, attachments, tools or parts that were not manufactured by Ag Spray Equipment, whether or not sold or operated with the Equipment; or (7) rubber parts, such as tires, hoses and grommets.

HOW TO OBTAIN WARRANTY SERVICE. To obtain warranty service under this Limited Warranty, you must (1) provide written notice to Ag Spray Equipment of the defect during the Warranty Period and within **thirty (30)** days after the defect becomes apparent or the repair becomes necessary, at the following address: Ag Spray Equipment, 1000 Fimco Lane, North Sioux City, SD 57049; and (2) make the Equipment available to Ag Spray Equipment or an authorized dealer within a reasonable period of time. For more information about this Limited Warranty, please call: **800-274-1025** or your local Ag Spray location.

WHAT REMEDIES ARE AVAILABLE UNDER THIS LIMITED WARRANTY. If the conditions set forth above are fulfilled and the Equipment or any part thereof is found to be defective, Ag Spray Equipment shall, at its own cost, and at its option, either repair or replace the defective Equipment or part. Ag Spray Equipment will pay for shipping and handling fees to return the repaired or replacement Equipment or part to you.

LIMITATION OF IMPLIED WARRANTIES AND OTHER REMEDIES. THE REMEDIES DESCRIBED ABOVE ARE YOUR SOLE AND EXCLUSIVE REMEDIES, AND AG SPRAY EQUIPMENT'S SOLE LIABILITY, FOR ANY BREACH OF THIS LIMITED WARRANTY. TO THE EXTENT APPLICABLE, ANY IMPLIED WARRANTIES, INCLUDING, WITHOUT LIMITATION, THE IMPLIED WARRANTIES OF MERCHANTABILITY AND FITNESS FOR A PARTICULAR PURPOSE, SHALL BE LIMITED IN DURATION TO THE WARRANTY PERIOD, AND THE REMEDIES AVAILABLE FOR BREACH THEREOF SHALL BE LIMITED TO THE REMEDIES AVAILABLE UNDER THIS EXPRESS LIMITED WARRANTY. SOME STATES DO NOT ALLOW LIMITATIONS ON HOW LONG AN IMPLIED WARRANTY LASTS, SO THE ABOVE LIMITATION MAY NOT APPLY TO YOU. IN NO EVENT SHALL AG SPRAY EQUIPMENT'S LIABILITY UNDER THIS LIMITED WARRANTY EXCEED THE ACTUAL AMOUNT PAID BY YOU FOR THE DEFECTIVE EQUIPMENT, NOR SHALL AG SPRAY EQUIPMENT BE LIABLE, UNDER ANY CIRCUMSTANCES, FOR ANY CONSEQUENTIAL, INCIDENTAL, SPECIAL OR PUNITIVE DAMAGES OR LOSSES, WHETHER DIRECT OR INDIRECT. SOME STATES DO NOT ALLOW THE EXCLUSION OR LIMITATION OF INCIDENTAL OR CONSEQUENTIAL DAMAGES, SO THE ABOVE LIMITATION OR EXCLUSION MAY NOT APPLY TO YOU.